

“JBP” SERIES FILTER SYSTEMS OPERATIONAL MANUAL



WARNING!

High pressure air has
Tremendous Kinetic Energy
and should be treated with the
utmost caution.

Shut off any valves on storage
cylinders, fill station, or air
control panels. Depressurize
system slowly before starting any
service work.

This reduces risk of
Explosive Venting

General instructions for filter maintenance

1. Dry inside of filter housing with a clean cloth before installing new cartridge and check for corrosion.
2. Lubricate threads and o-rings as well as threads on filter chamber.
3. Observe number of operating hours to ensure compliance with service intervals.
4. Change cartridge before returning to service any compressor that has out of service for more than six months.
5. Leave cartridge in the filter chamber as long as the unit is out of service, in order to absorb moisture in the filter system.
6. Keep all condensate drain-valves and shut-off valves closed. Maintain a minimum pressure of approximately 50 to 80 barg (700 to 1000 psig) within the system to prevent moisture entering the filter system.

Maintenance intervals

7. Replace cartridges every six months or according to Securus indicator.
8. All o-rings and back-up rings are to be changed with filters; lower filter cap o-ring and back-up ring changed annually.
9. Service check valve annually; replace kit.
10. Service auto drain annually; replace kit.
11. PMV serviced annually replace kit.
12. See respective section for complete procedures.

SERVICE OF THE SEPARATOR CHECK VALVE

The separator non return valve is located after the outlet of the final oil and water separator

1. Ensure that the separator is vented of all pressure and the filter towers are also depressurized
2. Remove the valve from the system and remove the tube connection fittings so that the internal poppet can be removed
3. Clean and check the valve for any seat damage
4. The poppet assembly is to be replaced annually, the complete valve is to be replaced if there is any leakage or seat body wear or damage noticed during inspection
5. Thoroughly clean the body of all lubricant or oil emulsions
6. Lubricate all contacts surfaces in the body and install the poppet with the new seals
7. Install the valve in the system while ensuring the valve is oriented in the correct direction of the airflow



J-CV-7000-J-15-6FSAE-B
Check Valve Complete



J-CV-7000-J-KIT-B
Brass Check Valve Kit

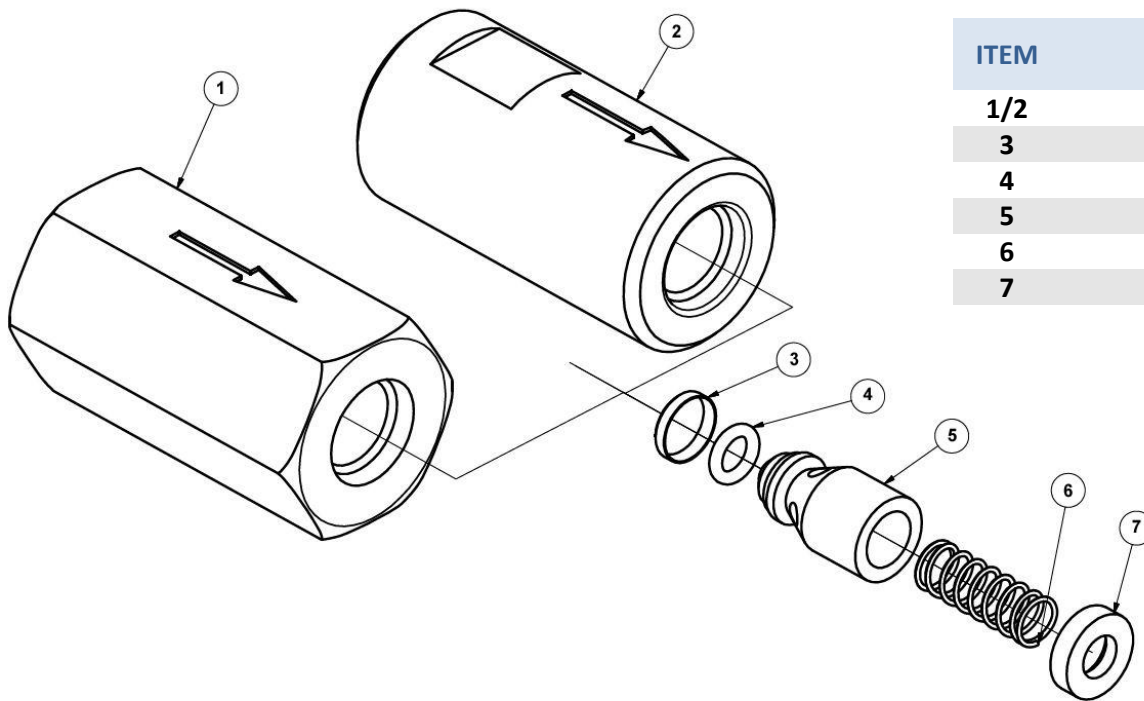

| ITEM | DESCRIPTION |
|------|-------------|
| 1/2 | Body |
| 3 | Spindle |
| 4 | Seat |
| 5 | Sleeve |
| 6 | Spring |
| 7 | O-ring |